

Wall Mount Kit

Quick Installation Guide

Package Contents

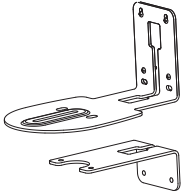

L - Mount Brackets



M4 x 8mm Screws (x2)



1/4"-20, L=7.5mm Screw (x1)

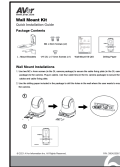

Wall Mount Kit QIG

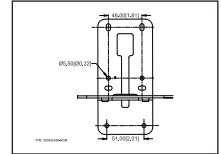

Drilling Paper

Wall Mount Installations

1. Use two M2 x 4mm screws (in the DL camera package) to secure the cable fixing plate (in the DL camera package) to the camera. Plug in cables. Use four cable ties (in the DL camera package) to secure the cables and cable fixing plate.
2. Use the drilling paper included in the package to drill the holes in the wall where the user wants to mount the camera.

①

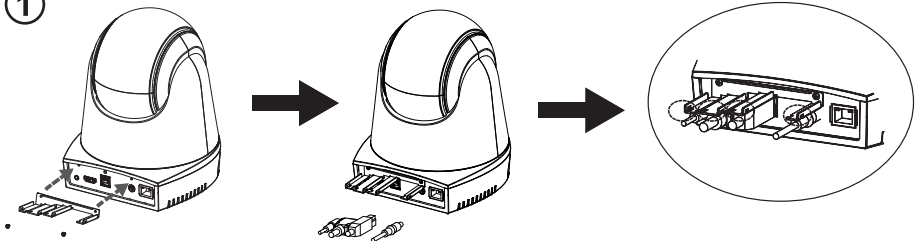

②

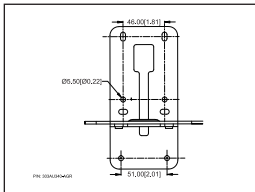

3. Use the screws (not included) to secure the L-mount bracket **A** on the wall.

[Note] For cement wall: M4 x 20mm self-tapping screws (x4) + plastic conical anchor

For wooden wall: M4 x 20mm self-tapping screws (x4)

4. Then, assemble the L-mount brackets **A** + **B** with 2 screws (M4 x 8mm, included in the package).

5. After assembling the L-mount brackets, use the screws (not included) to secure the lower part of L-mount brackets on the wall.

[Note] For cement wall: M4 x 20mm self-tapping screws (x2) + plastic conical anchor

For wooden wall: M4 x 20mm self-tapping screws (x2)

6. Pass the cables through the hole on the L-mount brackets and connect the cables to corresponding connection ports.

7. Use the remaining screw (1/4"-20, L=7.5mm, included in the package) to secure the camera on the L-mount brackets.

